

# SEZIONE A - A

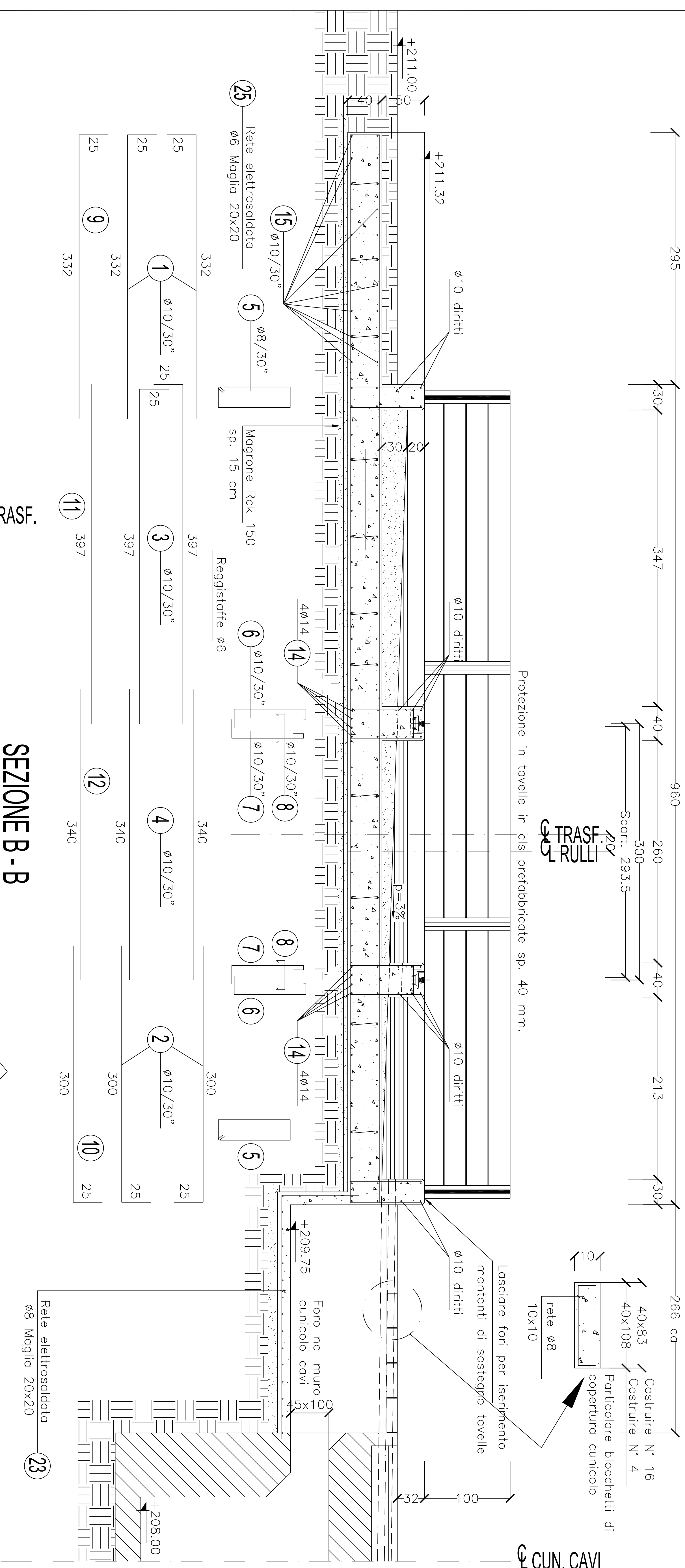

## SEZIONE B - B

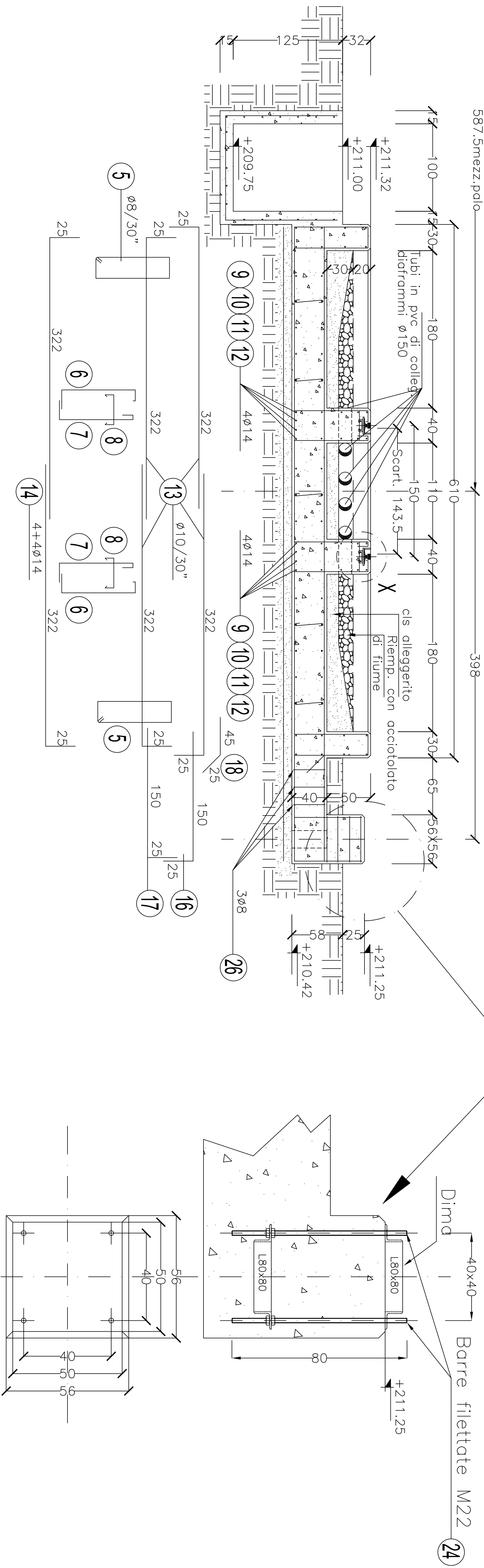

## SEZIONE C - C

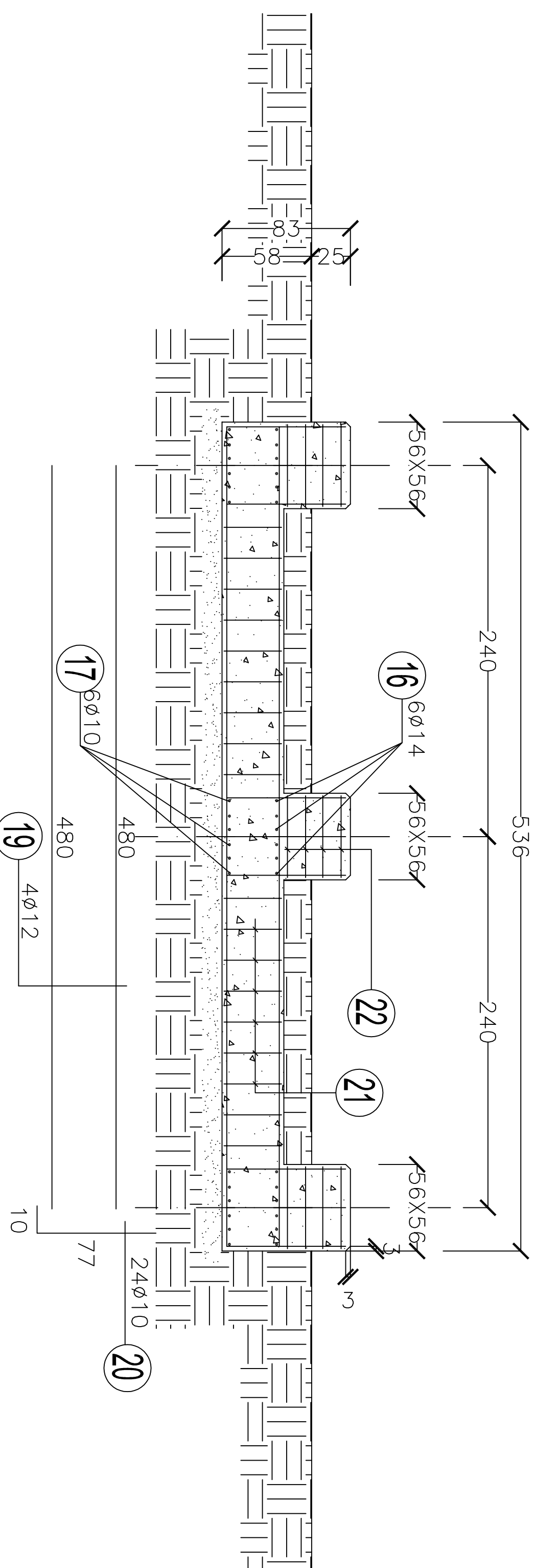

PARTICOLARE ANCORAGGIO COLONNE  
Scala 1:20

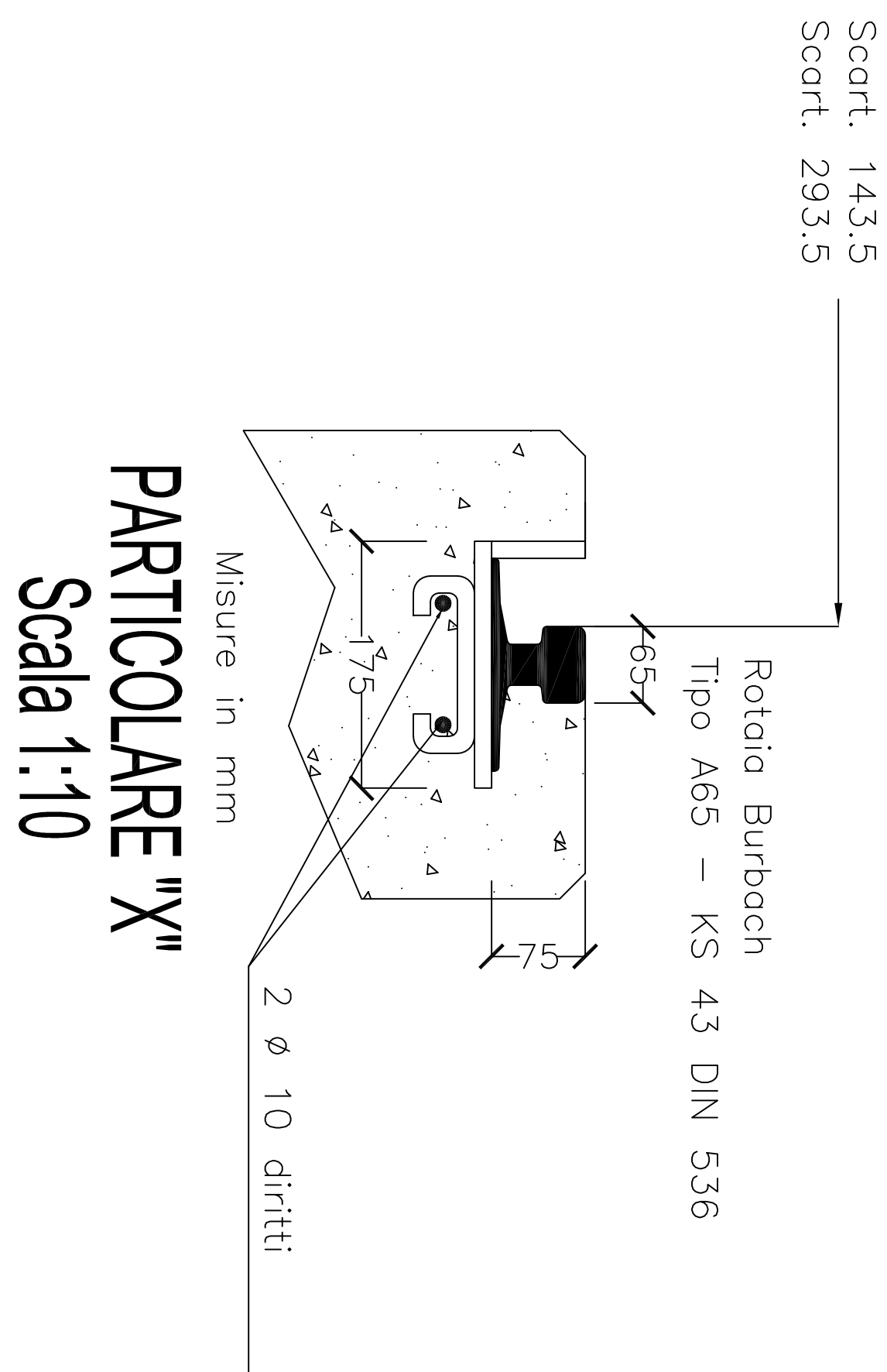

NOTE:

Le misure sono in cm.



Per dis. in pianta ved. dis. N° S010F000501\_1-3

Ved. anche dis. N° S010F000501\_3-3

Acciaio FEB 44 K KG. 1650.00

Calcestruzzo Rck 300 m<sup>3</sup> 46.00

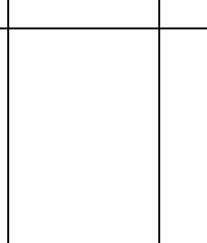
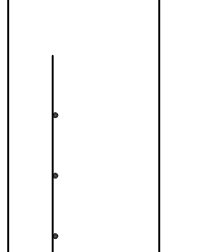
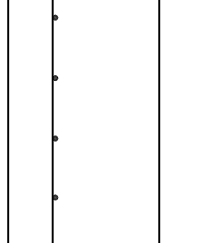
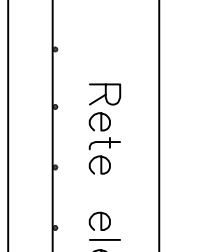
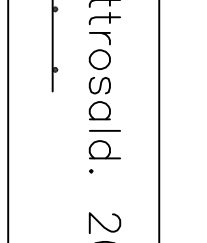
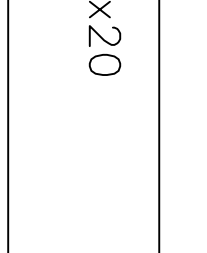
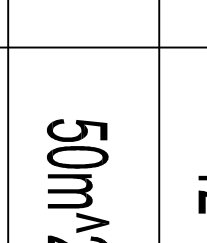
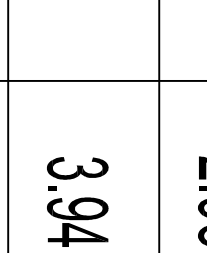
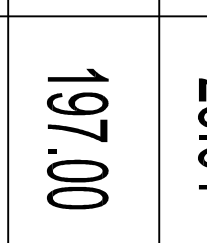
Calcestruzzo Rck 150 m<sup>3</sup> 12.00

26	8		SV.=180 cm	3	0.395	2.13
25	6		Rete elettrosold. 20x20	72mm2	2.22	159.84
24	22		Barro filatoio M22	12	2.98	28.61
23	8		Rete elettrosold. 20x20	50mm2	3.94	197.00
22	8		SV.=220 cm	12	0.395	10.43
21	6		SV.=110 cm	18	0.222	4.39
20	10		10	24	0.617	12.88
19	12		480	4	0.888	17.05
18	10		25	18	0.617	7.77
17	10		25	18	0.617	19.43
16	14		25	18	1.21	38.11
15	10		25	20	0.617	36.28
14	14		322	16	1.21	67.18
13	10		322	128	0.617	274.05
12	14		340	8	1.21	32.91
11	14		297	8	1.21	28.75
10	14		300	8	1.21	31.46
9	14		332	8	1.21	34.55
8	10		SV.=65 cm	125	0.617	50.13
7	10		SV.=123 cm	125	0.617	94.10
6	10		SV.=122 cm	125	0.617	94.10
5	8		SV.=230 cm	107	0.395	97.21
4	10		340	40	0.617	83.91
3	10		297	40	0.617	79.47
2	10		300	40	0.617	80.21
1	10		332	16	0.617	35.24
POS.	Ø	DESCRIZIONE		Q.TA' N°	P UNIT. KG./m	P TOT.KG

[illegible]